



Flat 2,

42 Roseville Street, St. Helier, JE2 4EP

Asking price £379,000



FLYING FREEHOLD - Reside are pleased to this modern and spacious two bedroom ground floor apartment, offering a perfect blend of modern living, located on the outskirts of St Helier.

This apartment boasts bright and airy interiors and high-quality finishes. There is an open plan kitchen and living area, with plenty of room for a dining area, double doors lead out onto a good sized patio.

There are two generously sized double bedrooms, offering ample space for storage and a modern house bathroom.

Close to local amenities, town centre, public transport links and Harve Des Pas. No allocated parking, however on-street parking and two public car parks nearby.

Viewings are highly recommended.

RES367



reside.je



info@reside.je



07797737773



reside.je



info@reside.je



07797737773

Floor Plan

GROUND FLOOR
528 sq.ft. (49.1 sq.m.) approx.

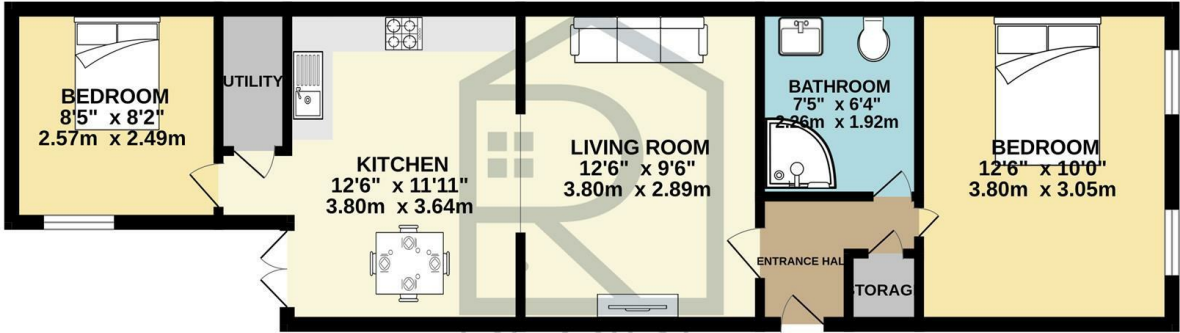

TOTAL FLOOR AREA : 528 sq.ft. (49.1 sq.m.) approx.
Whilst every attempt has been made to ensure the accuracy of the floorplan contained here, measurements of doors, windows, rooms and any other items are approximate and no responsibility is taken for any error, omission or mis-statement. This plan is for illustrative purposes only and should be used as such by any prospective purchaser. The services, systems and appliances shown have not been tested and no guarantee as to their operability or efficiency can be given.
Made with Metropix ©2025



reside.je



info@reside.je



07797737773

Key Information

- Garden Apartment
- Two Bedrooms
- Recently Renovated
- Public Parking Nearby
- Short Distance to Town Centre & Havre des Pas

Directions

